

MMC23709L

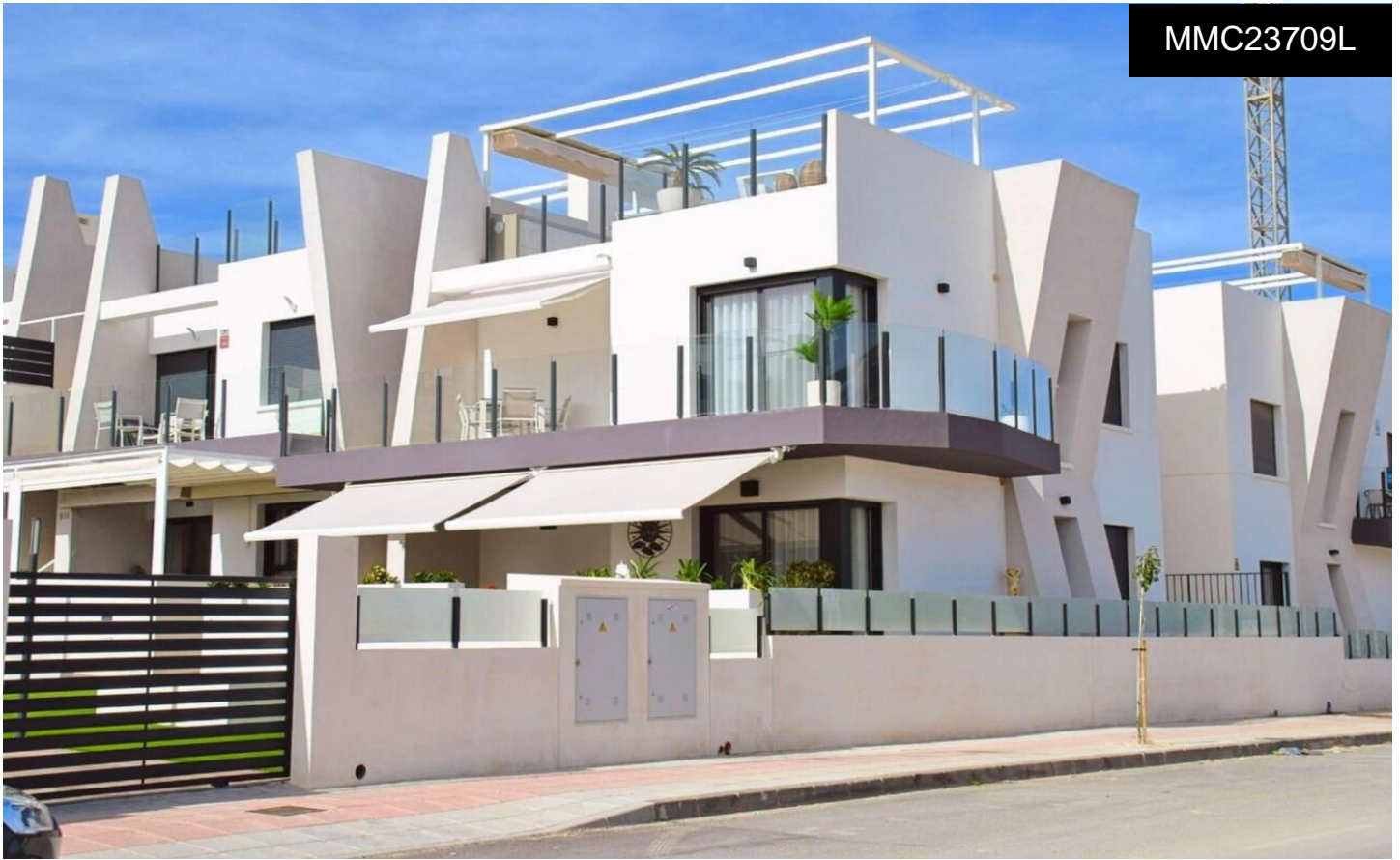

Apartment in San Miguel de Salinas

€299,000



2



2



70m²



N/A



Luxury South-Facing Corner Penthouse with Exceptional Solarium & Panoramic Views We are delighted to present this stunning south-facing corner penthouse apartment in San Miguel de Salinas, offering uninterrupted views across the Torrevieja Salt Lakes and towards the historic castle beyond. Overlooking the beautifully maintained communal pool and gardens, this modern home â€” built in 2024 â€” has been uniquely designed to maximise both indoor comfort and exceptional outdoor living. Ideally situated close to all local amenities, this penthouse immediately stands out thanks to its exclusive corner layout, unlike any other property within the development. Its elevated position, expansive windows, and south-facing orientation fill the home with natural light throughout